

MVL-KF1628M-12MP

1.1" 16 mm 12 MP FA LENS

KF series FA Lens are optimized for machine vision light sources and sensors, with high resolution, excellent image uniformity, high transmittance and good stability. Featured with fixed focal length, manual aperture and compact size, it is suitable for machine vision industry applications.



Key Features

- High resolution, high definition of the whole image
- Low distortion, high illumination relative
- Maximum image circle of 1.1"
- Support ultra-short working distance, maintaining excellent optical properties at different object distances

Distortion

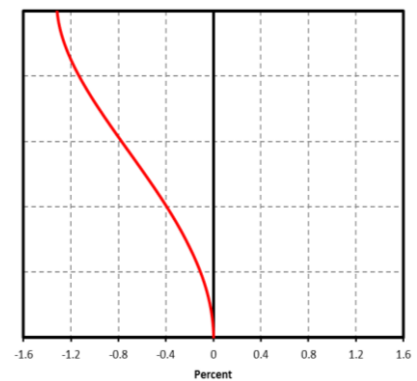

MTF

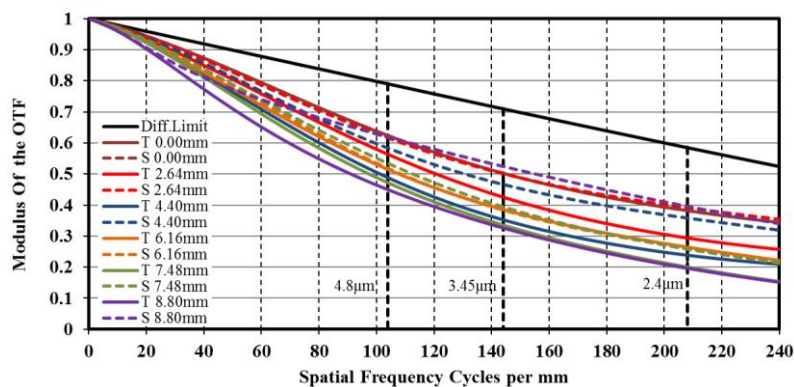

Relative Illumination

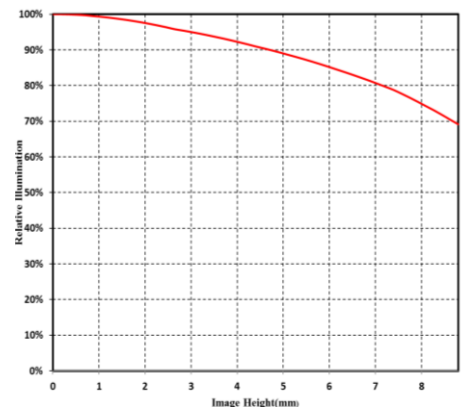

Note: The above curves are the simulate results based on F2.8, $\beta=-0.038$, WD=400 mm.

Specification

Model	MVL-KF1628M-12MP
Parameter	Fixed focal length, Manual iris, 12 MP, FA Lens
Performance	
Focal length	16 mm
F-number	F2.8 to F16
Image size	Ø17.6 mm
Optical distortion	-1.30%
Minimum object distance	0.1 m
Field of view	D (17.52mm): 54.8° H (14.14mm): 44.9° V (10.35mm): 33.9°
Mechanical	
Iris control	Manual
Focus control	Manual
Filter thread	M35.5 × 0.5
Mount	C-mount
Flange back length	17.526 mm
Dimension	Ø38.6 mm × 48.56 mm (Ø1.5" × 1.9")
Weight	146 g (0.3 lb.)
Temperature	-10°C to 50°C (14°F to 122°F)
General	
Certification	RoHS 2.0

Dimension

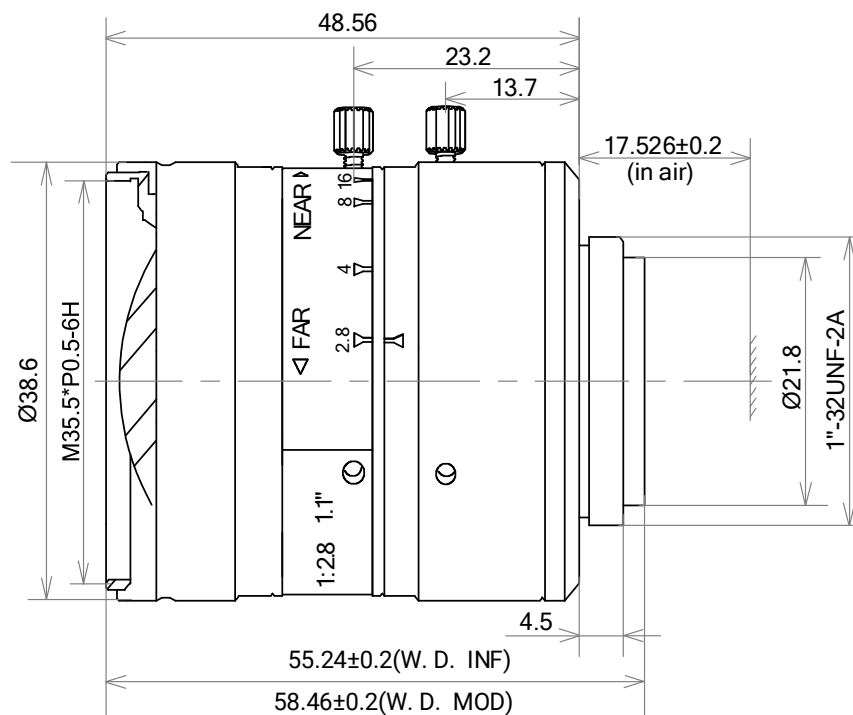

Unit: mm

Field of View

Extension (mm)	Working Distance (mm)	Magnification	Field of View (mm)					
			1.1"		1"		2/3"	
			H (14.14mm)	V (10.35mm)	H (12.45mm)	V (9.83mm)	H (8.45mm)	V (7.07mm)
5	25	-0.396	36.90	26.63	32.27	25.25	21.62	18.03
2	50	-0.246	59.25	42.83	51.86	40.62	34.79	29.02
1	75	-0.178	81.82	59.24	71.67	56.19	48.14	40.17
0	100	-0.139	104.30	75.52	91.37	71.63	61.38	51.21
	150	-0.097	149.36	108.43	131.02	102.88	88.21	73.64
	200	-0.074	194.17	141.18	170.45	133.96	114.91	95.95
	250	-0.060	238.86	173.85	209.79	164.99	141.55	118.23
	300	-0.051	283.51	206.49	249.09	195.97	168.17	140.48
	350	-0.044	328.12	239.10	288.36	226.94	194.76	162.71
	400	-0.038	372.71	271.70	327.61	257.89	221.35	184.94
	450	-0.034	417.29	304.29	366.85	288.83	247.93	207.16
	500	-0.031	461.86	336.88	406.08	319.77	274.50	229.37
	550	-0.028	506.42	369.46	445.31	350.71	301.07	251.58
	600	-0.026	550.98	402.03	484.53	381.64	327.64	273.79
	650	-0.024	595.54	434.61	523.75	412.56	354.20	296.00
	700	-0.022	640.09	467.18	562.96	443.49	380.77	318.21
	750	-0.021	684.64	499.75	602.18	474.41	407.33	340.41
	800	-0.020	729.19	532.32	641.39	505.33	433.89	362.62
	850	-0.018	773.73	564.88	680.60	536.25	460.45	384.82
900	-0.017	818.28	597.45	719.81	567.17	487.01	407.03	
1000	-0.016	907.37	662.58	798.22	629.01	540.12	451.43	

HIKROBOT

Hangzhou Hikrobot Co. Ltd.
en.hikrobotics.com

© Hangzhou Hikrobot Co., Ltd. All Rights Reserved.

Hangzhou Hikrobot does not tolerate any infringement. Any organization or individual may not imitate or reproduce in whole or in part of the content. The data herein is based on Hikrobot's internal evaluation. Actual data may vary depending on specific configuration and operating condition. The information herein is subject to change without notice. All the content has been checked conscientiously. Nevertheless, Hikrobot shall not be liable to damages resulting from errors, inconsistencies or omissions.