

MV-CL083-B0F2C

8192 P XoFLink Line Scan Camera

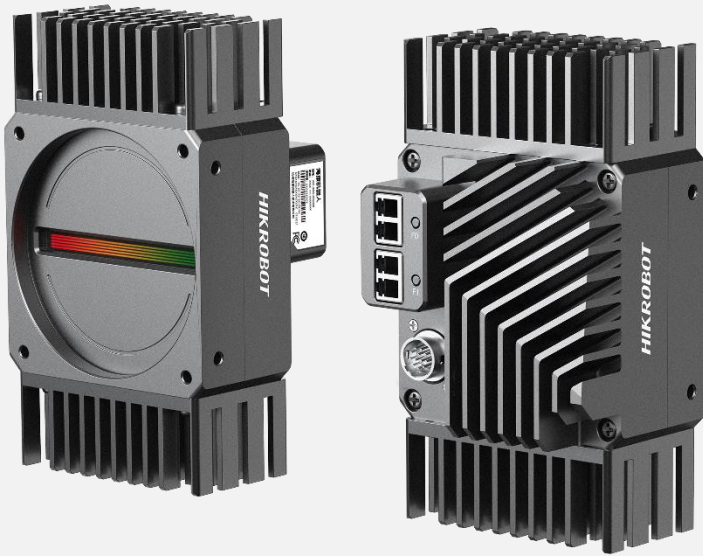

GEN<i>i>CAM

XoFLink

Introduction

MV-CL083-B0F2C camera adopts 8192 × 3 CMOS sensor and supports dual-channel XoFLink data transmission, and its max. line rate reaches 71 kHz. It integrates multiple advanced ISP image processing technologies, and is featured with high speed, high accuracy, and high performance.

Key Feature

- Adopts multiple ISP image processing technologies, such as Gamma correction, flat field correction, LUT, black level, etc.
- Supports RGB true color and multiple exposure and acquisition modes.
- Supports dual-channel XoFLink data transmission, and its max. line rate reaches 71 kHz.
- Compact design and flexible installation.

Dimension

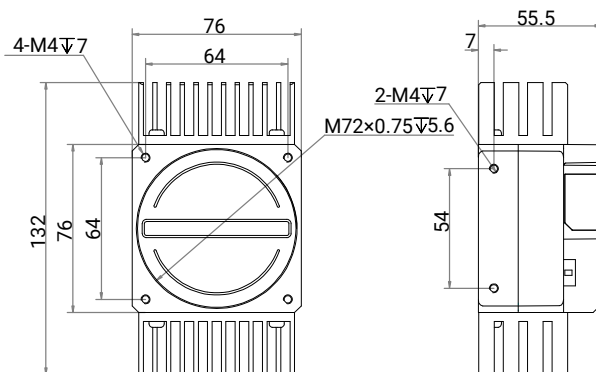

Available Model

MV-CL083-B0F2C

Applicable Industry

New energy, printing, screen detection, consumer electronics, PCB, semiconductor, etc.

Sensor Quantum Efficiency

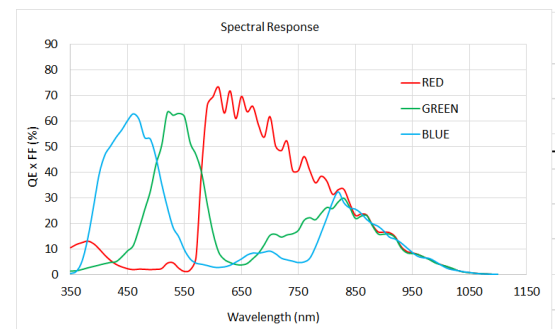

Specification

Model	MV-CL083-B0F2C
Specifications	8192 P XoFLink Line Scan Camera
Performance	
Sensor type	CMOS
Pixel size	7 μm \times 7 μm
Resolution	8192 \times 3
Image mode	1-Line
Max. line rate	71 kHz
Transmission mode	1 Link, 2 Link
Dynamic range	61.2 dB
SNR	40.1 dB
Gain	1.0 \times , 2.0 \times , 3.0 \times , 4.0 \times
Exposure time	3 μs to 10 ms
Exposure mode	Off/ Once/ Continuous exposure mode, and supports fixed exposure time and trigger-width exposure time
Mono/color	Color
Pixel format	RGB 8, BGR 8, Mono 8, Bayer RG 8/10
Binning	Supports 1 \times 1, 1 \times 2, 1 \times 4, 2 \times 1, 2 \times 2, 2 \times 4, 4 \times 1, 4 \times 2, 4 \times 4
Reverse image	Supports horizontal reverse image output
Trigger mode	External trigger, internal trigger
External trigger mode	Line trigger
Electrical feature	
Data interface	2LC fiber interface
Digital I/O	Not supported
Power supply	12 VDC to 24 VDC
Power consumption	Typ. 15.8 W @ 12 VDC
Mechanical	
Lens mount	M72*0.75, flange back length 12 mm, applicable to F-mount via lens adapter
Dimension	132 mm \times 76 mm \times 55.5 mm (5.2" \times 3.0" \times 2.2")
Weight	Approx. 600 g (1.3 lb.)
Ingress protection	IP40 (under proper lens installation and wiring)
Temperature	Working temperature: -20 $^{\circ}\text{C}$ to 50 $^{\circ}\text{C}$ (-4 $^{\circ}\text{F}$ to 122 $^{\circ}\text{F}$) Storage temperature: -30 $^{\circ}\text{C}$ to 80 $^{\circ}\text{C}$ (-22 $^{\circ}\text{F}$ to 176 $^{\circ}\text{F}$)
Humidity	5% RH to 90% RH (no condensation)
General	
Client software	MVS
Operating system	32/64-bit Windows 7/10, 64-bit Windows 11, 32/64-bit Linux
Compatibility	XoFLink, GenICam
Certification	CE, RoHS, KC