

MV-CH240-10TM

24 MP CMOS 10 GigE Area Scan Camera



GEN<i>i</i>CAM

10GiGE
VISION

Introduction

MV-CH240-10TM camera adopts Sony® IMX540 sensor to provide high-quality images with high resolution and low noise. It uses 10 GigE interface to transmit non-compressed data in real time, and its max. frame rate can reach 35.1 fps in full resolution.

Key Feature

- Resolution of 5328 × 4600, and pixel size of 2.74 μm × 2.74 μm.
- Supports auto or manual adjustment of gain, exposure time, and manual adjustment of Gamma correction, LUT, etc.
- Adopts 10 GigE interface, compatible with GigE, and max. transmission distance of 100 meters.
- Compact design with mounting holes on panels for flexible mounting.
- Compatible with GigE Vision V2.0 Protocol, GenICam Standard, and third-party software based on the protocol and standard.

Available Model

C-mount without fan, mono: MV-CH240-10TM-C-NN

Applicable Industry

Consumer electronics, electronics and semiconductor, photovoltaics, railway related application, etc.

Sensor Quantum Efficiency

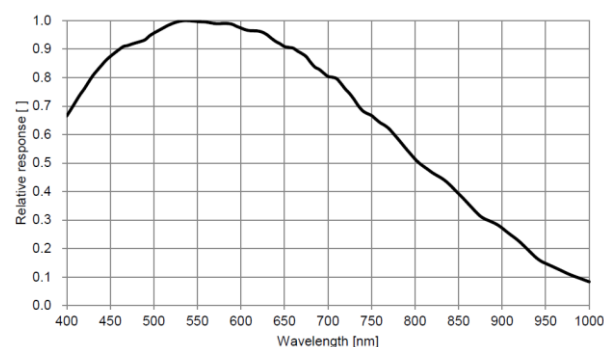

Specification

Model	MV-CH240-10TM
Camera	
Sensor type	CMOS, global shutter
Sensor model	Sony® IMX540
Pixel size	2.74 μm × 2.74 μm
Sensor size	1.2"
Resolution	5328 × 4600
Max. frame rate	35.1 fps @ 5328 × 4600 Mono 8
Dynamic range	71 dB
SNR	40 dB
Gain	0 dB to 24 dB
Exposure time	UltraShort exposure mode: 1 μs to 7 μs Standard exposure mode: 8 μs to 10 sec
Exposure mode	Off/Once/Continuous exposure mode
Mono/Color	Mono
Pixel format	Mono 8/10/10Packed/12/12Packed
Binning	Supports 1 × 1, 2 × 2
Decimation	Supports 1 × 1, 1 × 2, 1 × 4, 2 × 1, 2 × 2, 2 × 4, 4 × 1, 4 × 2, 4 × 4
Reverse image	Supports horizontal and vertical reverse image output
Electrical feature	
Data interface	10 Gigabit Ethernet (10000 Mbit/s), compatible with Gigabit Ethernet (1000 Mbit/s)
Digital I/O	12-pin P10 connector provides power and I/O, including opto-isolated input × 1 (Line 0), opto-isolated output × 1 (Line 1), bi-directional non-isolated I/O × 1 (Line 2), RS-232 × 1
Power supply	9 VDC to 24 VDC
Power consumption	Typ. 10 W @ 12 VDC
Mechanical	
Lens mount	C-mount
Dimension	84 mm × 84 mm × 92.5 mm (3.3" × 3.3" × 3.6")
Weight	Approx. 600 g (1.3 lb)
Ingress protection	IP40 (under proper lens installation and wiring)
Temperature	Working temperature: 0 °C to 50 °C (32 °F to 122 °F) Storage temperature: -30 °C to 70 °C (-22 °F to 158 °F)
Humidity	20% RH to 95% RH (no condensation)
General	
Client software	MVS or third-party software meeting with GigE Vision Protocol
Operating system	32/64-bit Windows 7/10, 64-bit Windows 11, and 32/64-bit Linux
Compatibility	GigE Vision V2.0, GenICam
Certification	CE, RoHS, KC

Dimension

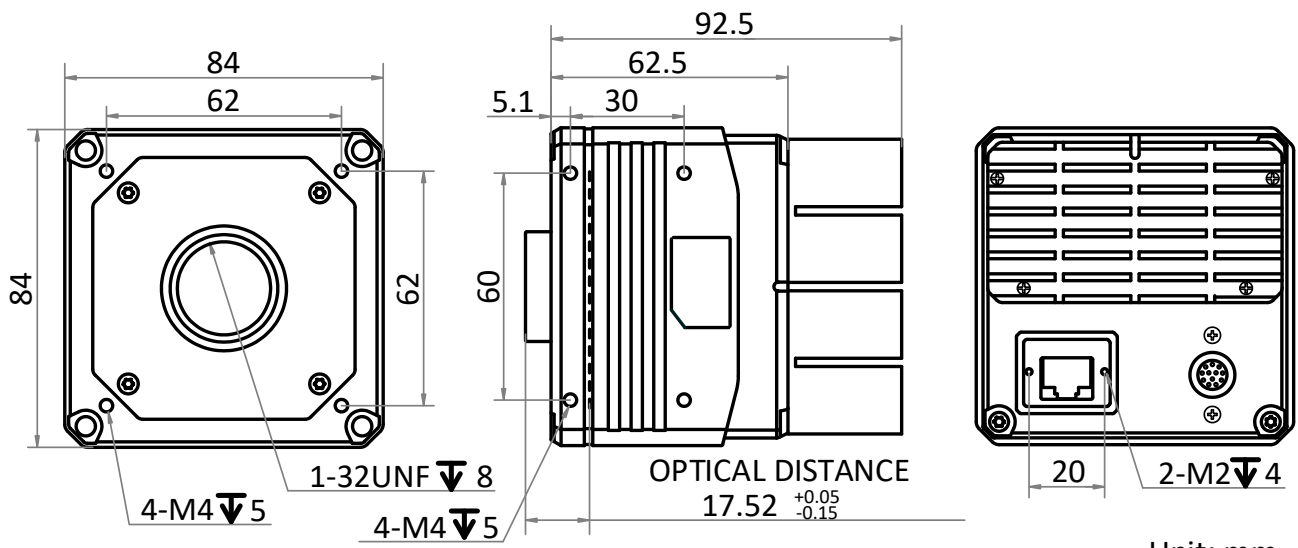

Unit: mm